

Applying JAC Films



Guideline for use 1.3

Issue date : 12 March 2003

Introduction

Performance of JAC films is strongly depending on proper application of the product. Most problems can be related to wrong application methods. Underneath application methods will be explained.

Please note that initial adhesion of all self adhesive films is lower than adhesion after 24 h. So do not expose freshly applied films to tension and water.

Before application:

Prepare substrate for application as described in Guideline for use 1.0: 'Preparing substrates'.

Application temperature of substrate should be between +8°C and +40°C. Preferred temperature is 18°C.



Applying JAC Films



Guideline for use 1.3

Issue date : 12 March 2003

Application of small sizes < 0.8 m².



Always remove the liner from the marking rather than the other way round.
Before applying, lay marking on clean flat surface. Separate the liner from the marking by pulling the liner away in a continuous motion at a 180° angle.

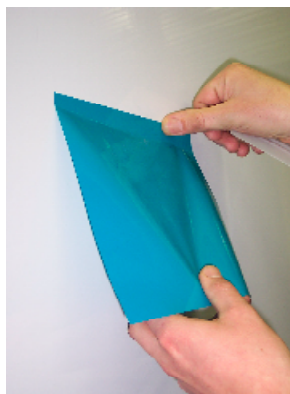

Position marking. Stick one edge of the marking onto the surface without leaving pleats or bubbles. Keep remainder of the marking off the substrate.

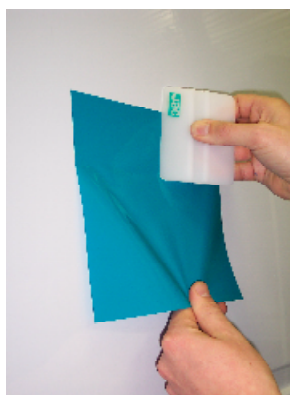

Start application at the middle of the already applied edge. Use a squeegee and firm pressure and apply marking in overlapping strokes from the center to the edges. Work towards your other hand still holding the marking off the substrate.

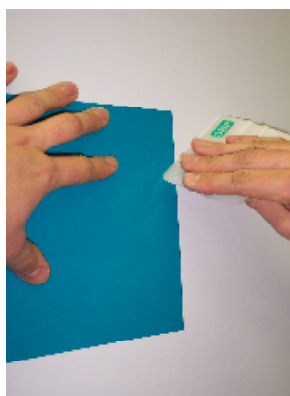

Bubbles can be pricked with a needle and squeezed out.
Re-squeegee the edges of the marking using very firm pressure.



Applying JAC Films



Guideline for use 1.3

Issue date : 12 March 2003

Application of medium sizes > 0.8 m².



Always remove the liner from the marking rather than the other way round.
Before applying, lay marking on clean flat surface. Separate the liner from the marking by pulling and folding ca. 5 cm. of the liner away.

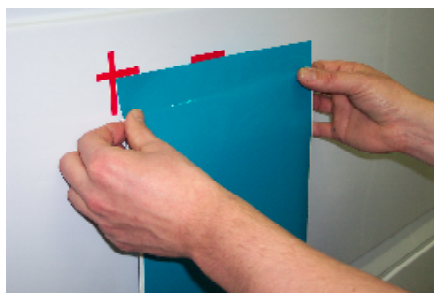

For proper positioning put reference marks onto the substrate. Use masking tape or any other easy to remove marker.

Position the marking using the reference marks. Apply sticky edge of the marking onto the surface without leaving pleats or bubbles.



Remove ca. 20 cm. of the liner. Keep marking close to substrate without contact. Start application at the middle of the already applied edge. Use a squeegee and firm pressure and apply marking in overlapping strokes from the center to the edges. Work towards your other hand still holding the marking off the substrate. Repeat until liner has been removed completely.

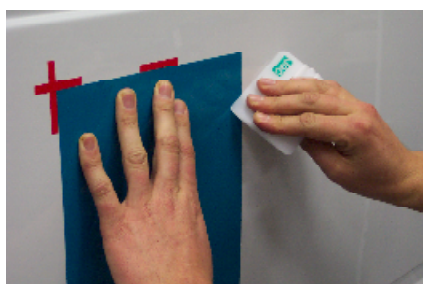

Bubbles can be pricked with a needle and squeezed out.
Re-squeegee the edges of the marking using very firm pressure.



Applying JAC Films



Guideline for use 1.3

Issue date : 12 March 2003

Application of large sizes

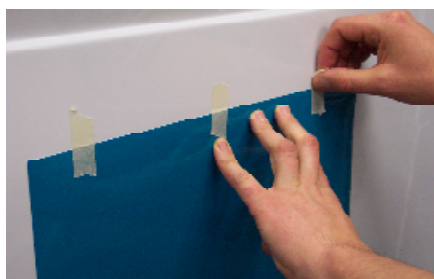

Position liner and marking on substrate using masking tape.



Create a horizontal tape hinge at the top of the marking.



Turn over marking and remove and fold ca. 20 cm. of the liner.

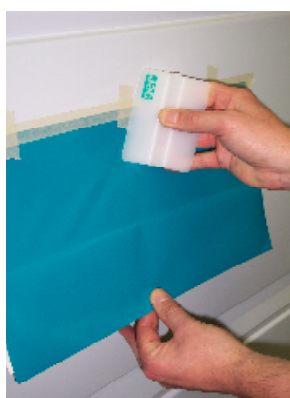

Turn back marking. Keep marking close to substrate without contact. Start application at the middle of the tape hinge. Use a squeegee and firm pressure and apply marking in overlapping strokes from the center to the edges. Work towards your other hand still holding the marking off the substrate. Repeat until liner has been removed completely.

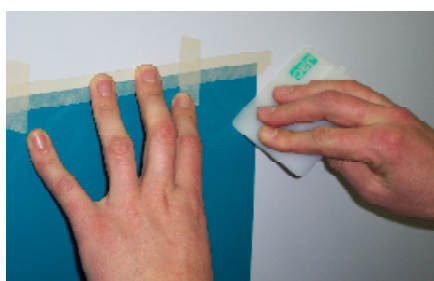

If air entrapments occur peel off marking carefully and retry.
Bubbles can be pricked with a needle and squeezed out.
Re-squeegee the edges of the marking using very firm pressure.



Applying JAC Films



Guideline for use 1.3

Issue date : 12 March 2003

Application of signcut markings

In order to apply signcut markings the use of application tape is needed.



The marking should be laminated completely with appropriate JAC TRANS application tape. This JAC product is a transfer media that keeps all details of the signcut marking in position. Depending on size, complexity and other characteristics of the marking application tape of paper or film can be used. See also our Guideline for use 2.0: 'Applying JAC TRANS' and/or contact your local JAC sales rep.

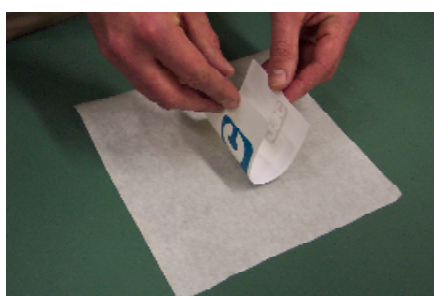

Lay down application tape with non-sticking side on clean flat surface. Drape marking on sticking side starting in the center.

Apply pressure by using a squeegee or a roller in order to increase adhesion between marking and tape.

Note: Large markings should be laminated by using laminating devices.



Always remove the liner from the marking rather than the other way round. Before applying, lay marking on clean flat surface. Separate the liner from the marking by pulling the liner away in a continuous motion at a 180° angle.

After removing the liner the signcut marking can be applied according instructions above.

Shortly after application remove the transfer tape from the marking by pulling the tape away in a continuous motion at a 180° angle.

Bubbles can be pricked with a needle and squeezed out.
Re-squeegee the edges of the marking using very firm pressure.



Applying JAC Films



Guideline for use 1.3

Issue date : 12 March 2003

Wet application of markings

Wet application is easier for inexperienced applicators. However it takes longer before the film reaches proper adhesion. In addition wet application can only be used for vinyl films on flat substrates. On windows please note that water based adhesion will cause visible milky spots on the reverse side of the marking.

Prior to application prepare substrate as described in Guideline for use 1.0: 'Preparing substrates'.

For proper positioning put reference marks onto the substrate. Use masking tape or any other easy to remove marker.

Put a small amount (teaspoon) of silicone free detergent into the water.
Wet the substrate in full.

Always remove the liner from the marking rather than the other way round.
Before applying, lay marking on clean flat surface. Separate the liner from the marking by pulling the liner away.

Put the marking on the water film. Position the marking using the reference marks.

Squeeze water and air to the edges of the marking. Use a squeegee, very firm pressure and overlapping strokes to squeeze all water to the edges of the marking. Use a sponge to absorb water.

Bubbles can be pricked with a needle and squeezed out.

Dry the marking and the substrate.
Allow marking to dry for about 24 h. at ca. 18°C free from humidity.

Re-squeegee the edges of the marking using very firm pressure.

